

MP2310MDGC

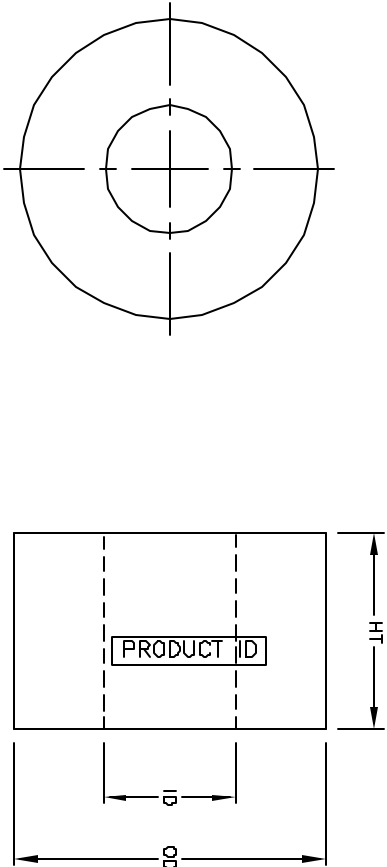

Coated Core Specifications				Bare Core Specifications		
PART NO.	OD mm	ID mm	HT mm	OD mm	ID mm	HT mm
MP2310MDGC	24.35	12.16	11.05	22.96	12.70	9.525
Tolerance (mm)	±0.6	±0.6	±0.6			

Core Designation	Material Dupont	Manufacturer UL File #	Insulation System
M	EFB534\$0	E206123	ClassB/ClassF

NOTE:

- PART IDENTIFICATION CODE AND MANUFACTURING DATE CODE ARE PRINTED ON CURVED SURFACE.
- MINIMUM COATING THICKNESS OF 0.127 mm (5 MILS) ON ANY POINT OF CORE IS MAINTAINED.
- ALL MEASUREMENTS ARE DONE AT ROOM TEMPERATURE.

MAGNETIC TOLERANCES: CORE MATERIAL: METGLAS® ALLOY 2605SA1.
PERMEABILITY ± 15%
Al ± 15%
Moss ± 3%

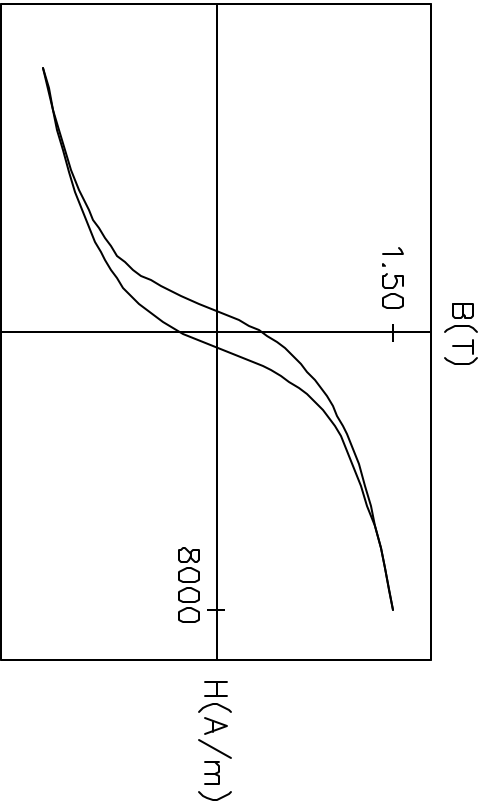

TYPICAL B-H LOOP

Performance Specifications							
l _m cm	A _c cm ²	Mass g	Vol cm ³	Initial Perm	Al nH	W _a cm ²	W _a A _c cm ⁴
5.60	0.425	17.09	1	2.38	245	257.5	1.16

Al is measured at 10 kHz/100 mV.
l_m = mean magnetic path length
A_c = net cross-sectional area
W_a = core window area

NOTE: ANY REVISION MADE TO THIS DRAWING MUST BE REFLECTED ON THE CORRESPONDING ISO DOCUMENT. THIS DRAWING IS NOT TO SCALE.				No	Revision		Approved by	Date	<div>Honeywell</div> <div>METGLAS® Solutions</div> <div>CONWAY, SC 29526.</div> <div>Part # MP2310MDGC</div> <div>Drawn by S.Matthews</div> <div>Date 10/21/98</div> <div>Checked by SR</div> <div>Date 07/19/01</div>
				Q	First release.		RH, RM, ST	07/19/01	